



CHATTERTON | REES



E, 483 Fulham Road
, London, SW6 1HJ

Asking price £475,000



E, 483 Fulham Road



Description

Ideally located this exceptional 1 bedroom flat boasts impressive levels of natural light due to its double fronted window aspect at the front and rear of the property in this pretty Victorian house. A large living area with a south facing balcony leads onto the modern separate kitchen. The bathroom is located just off the bedroom, which is a lovely large open space.

- Share of freehold
- 1 bedroom
- Impressive natural light
- Outside space
- Exceptional views
- Close to station





Floor Plan

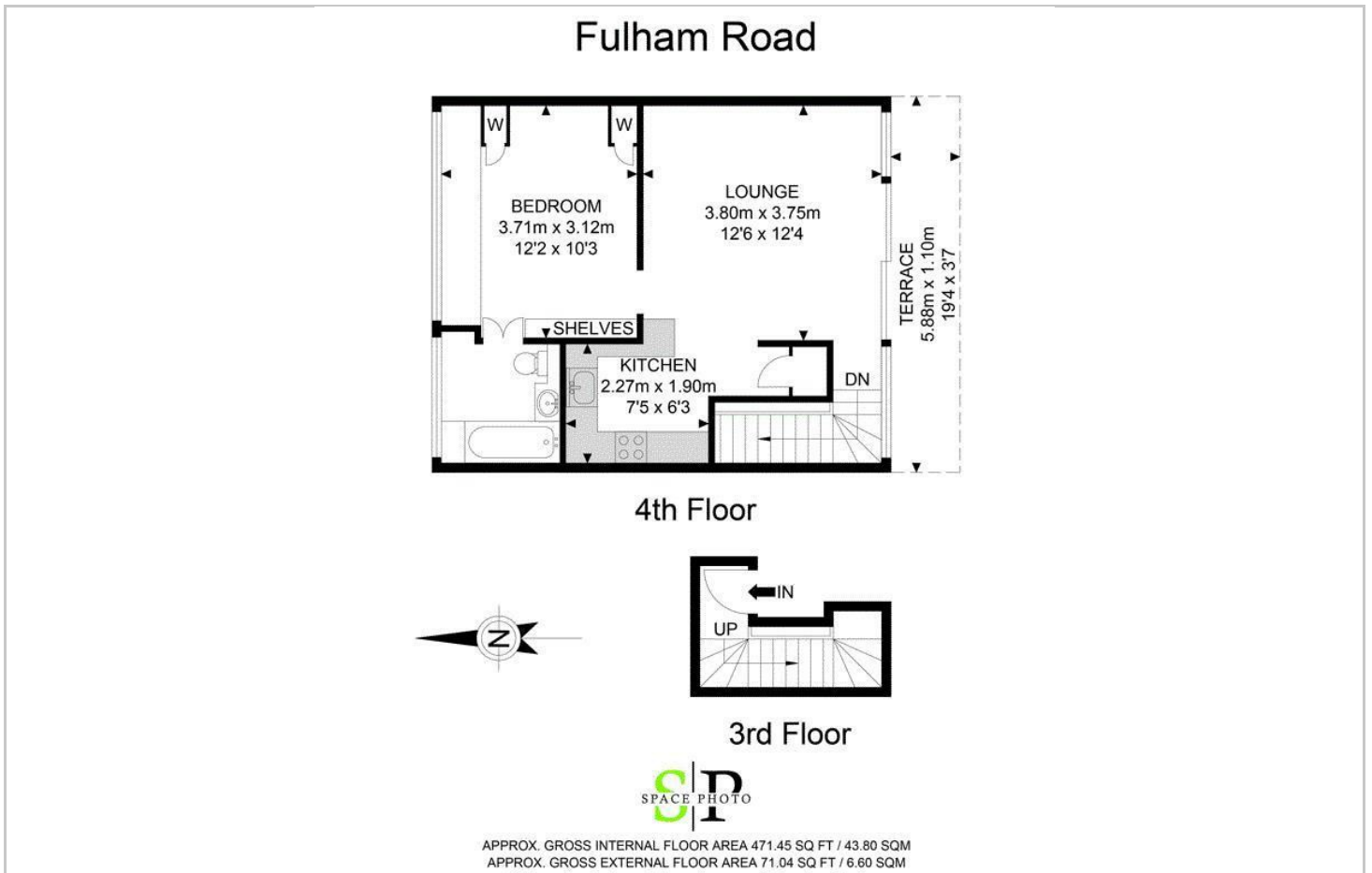

Area Map

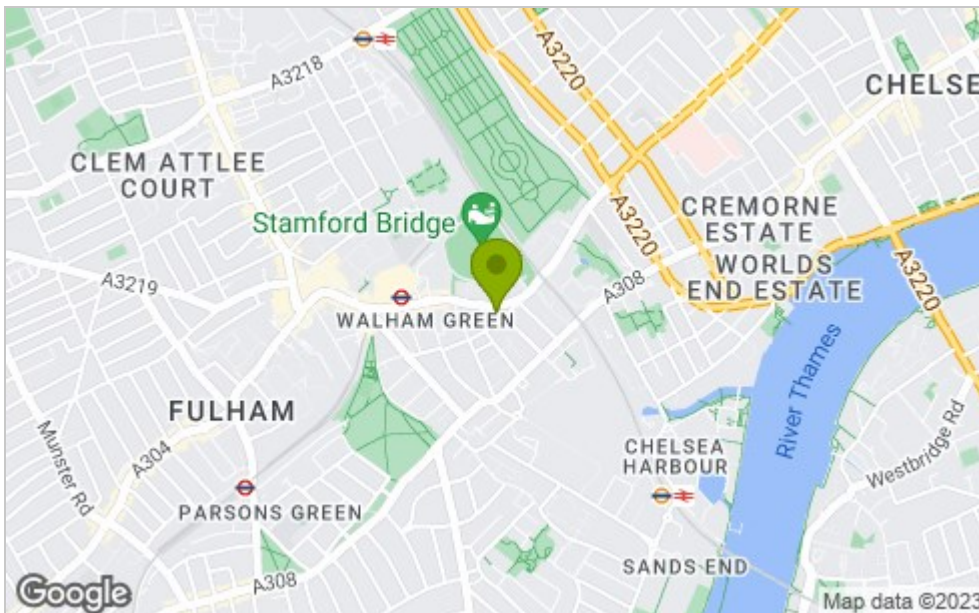

Viewing

Please contact our Chatterton Rees Office on 020 3780 0580 if you wish to arrange a viewing appointment for this property or require further information.

These particulars, whilst believed to be accurate are set out as a general outline only for guidance and do not constitute any part of an offer or contract. Intending purchasers should not rely on them as statements of representation of fact, but must satisfy themselves by inspection or otherwise as to their accuracy. No person in this firm's employment has the authority to make or give any representation or warranty in respect of the property.

Energy Efficiency Graph

Energy Efficiency Rating		Current	Potential
Very energy efficient - lower running costs			
(92 plus) A			
(81-91) B			
(69-80) C			
(55-68) D			
(39-54) E			
(21-38) F			
(1-20) G			
Not energy efficient - higher running costs			
England & Wales		EU Directive 2002/91/EC	
Environmental Impact (CO ₂) Rating		Current	Potential
Very environmentally friendly - lower CO ₂ emissions			
(92 plus) A			
(81-91) B			
(69-80) C			
(55-68) D			
(39-54) E			
(21-38) F			
(1-20) G			
Not environmentally friendly - higher CO ₂ emissions			
England & Wales		EU Directive 2002/91/EC	